

## RAILS "NG"

The present evolution of the GR type is passing through the realization of guideways that in spite of their smaller section are performing better features in respect of the carrying capacity and therefore of stiffness. This new kind of guideway named NG has two different sections whose dimensions are stated in the following page.

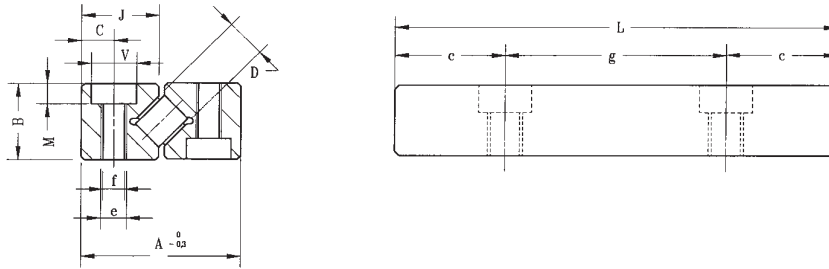

# Rails "NG"



Denomination	Guideway type	Weight in g	L	g	c	D	A	B	J	C	e	f	V	M
NG 4	NG 4 050	27	50	1x25										
	NG 4 075	41	75	2x25										
	NG 4 100	55	100	3x25										
	NG 4 125	69	125	4x25										
	NG 4 150	83	150	5x25										
	NG 4 175	97	175	6x25	12,5	4,5	19	9	9	3,5	M3	2,65	5,5	2,7
	NG 4 200	111	200	7x25										
	NG 4 225	125	225	8x25										
	NG 4 250	139	250	9x25										
	NG 4 275	153	275	10x25										
NG 4 300	167	300	11x25											
NG 6	NG 6 100	92	100	3x25										
	NG 6 150	138	150	5x25										
	NG 6 200	184	200	7x25										
	NG 6 250	230	250	9x25	12,5	6,5	25	12	12	5	M4	3,3	7	3,2
	NG 6 300	276	300	11x25										
	NG 6 350	322	350	13x25										
	NG 6 400	368	400	15x25										

## CAGES

### Type BN

With retained rollers; for horizontal and vertical stroke  
Material: delrin

Rail Type	Cage Type	t	D	C (N)
NG 4	BN 4	6,5	4,5	850
NG 6	BN 6	8,5	6,5	1800

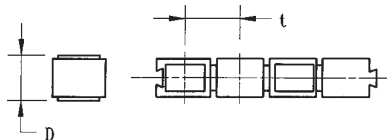

## FIXING SCREWS

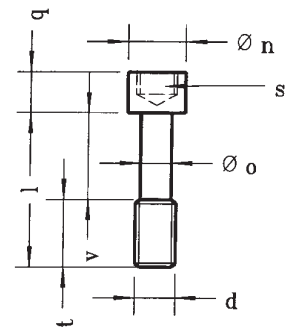

Dimensions	NG 4	NG 6
l	12	16
Øn	4,5	5,5
Øo	1,85	2,3
d	M2,5	M3
q	2,5	3
v	7	11
t	5	5
s	2	2,5
Code	VBN 4	VBN 6

## END PIECES

**NB** = for horizontal and vertical application

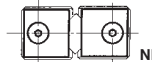

**NC** = for applications with guideways of different length.  
They are mounted on the longest guideways.  
They can be provided with race-wiper.

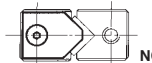

Rail Type	A1	A2
NG 4	4	5,5
NG 6	4	5,5

